

Quick Start Guide

快速启动指南

中文P11

WARNING
注意事项

1. Do not remove the wrapping around the nozzle.
 2. Hot! Avoid touching the heating nozzle in operation.
 3. Moving parts in printer may cause injury. Do not wear gloves or other sources of entanglement in operation.
1. 切勿去除包裹在喷嘴处的耐高温材料。
 2. 高温危险！打印机喷嘴在工作时会被加热，操作时请避免接触！
 3. 可动部件可能会造成卷入挤压和切割伤害。操作机器时请不要配带手套或缠绕物。

Unpacking



1. Open the box.



2. Remove wrapping paper box on the top, there is a Quick start, an after-sales service, an accessory kit, a power cable and a roll of material on the plastic box.



3. Take out the printer of the carton, remove bubble pack outside the printer.



4. Tear off fixed tapes and front door protective bag.



5. Take power cable out and plug it into power input.

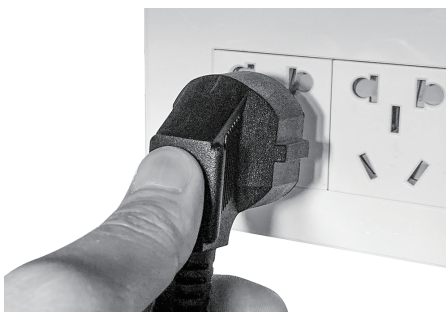

6. Plug the other end of power cable into socket, turn on the power switch.



7. Turn on the power switch.



8. Open the front door.

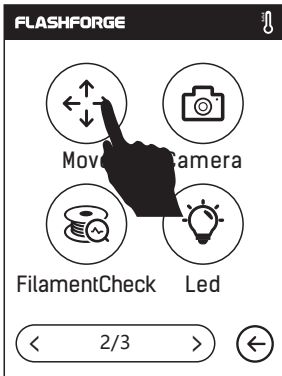
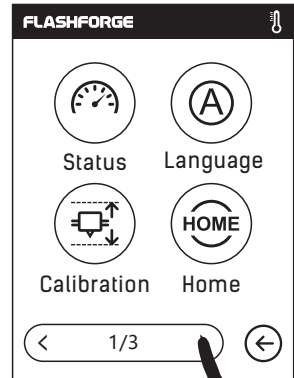
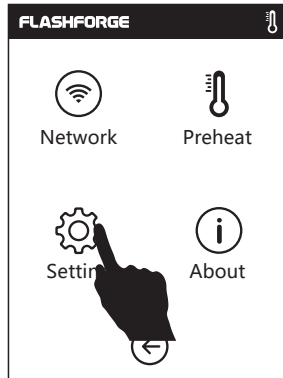
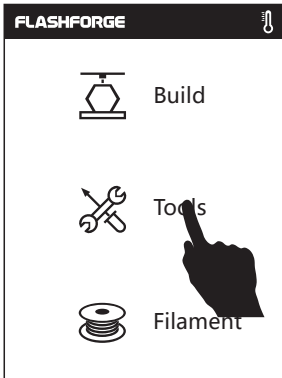

9. Tap [Tools]-[Setting] on the touch screen as the picture showed above, tap [Move].

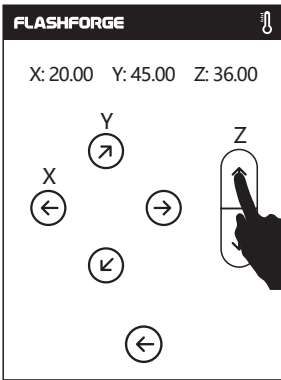

10. Tap the upper arrow in the moving page to make the extruder raises for removing the paper box on the bottom easier.

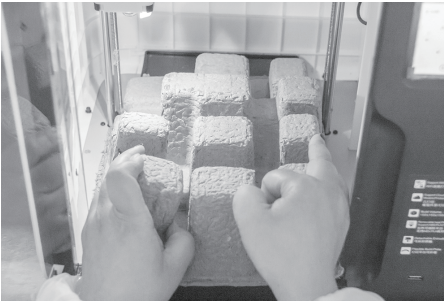

11. Squeeze wrapping paper box to the middle slightly and take it out.



12. Unboxing completed! Recommended that you take good care of packing materials for further carrying and keeping.

Kit Contents

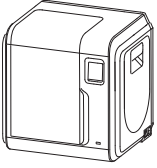

3D Printer



Filament



Power Cable



After-sales
service card



Quick Start Guide



Screwdriver

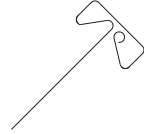

Unclogging Pin Tool



Allen Wrench

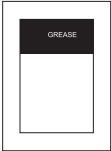

Grease

Getting to know your Adventurer 3

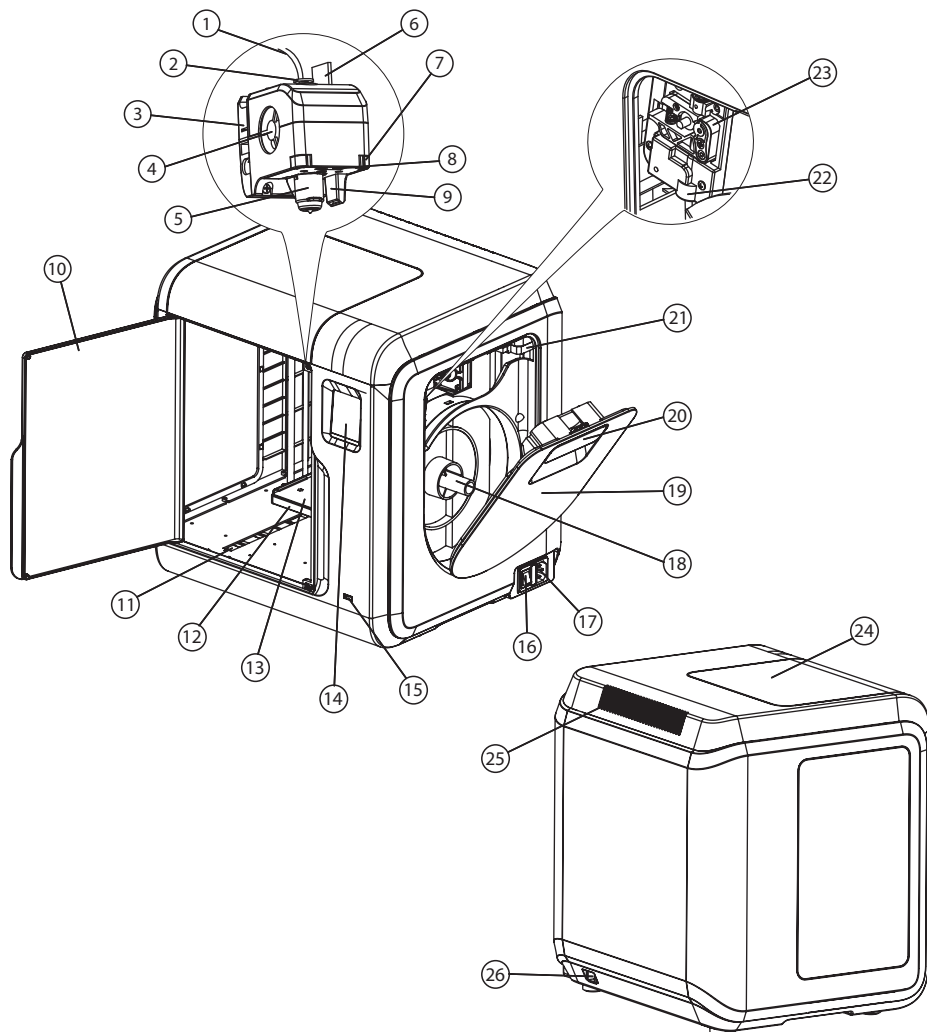

1. Filament guide tube 2. Filament guide tube joint 3. Extruder base 4. Cooling Fan
 5. Removable nozzle 6. Extruder cables 7. Clip 8. Led light
 9. Turbo Fan Baffle 10. Front door 11. Y-Axis sliding slot 12. Platform base
 13. Removable build plate 14. Touch-screen 15. USB stick input 16. Power switch
 17. Power input 18. Spool holder 19. Filament cover 20. Filament cover handle
 21. Moto 22. Filament intake 23. Filament feeding wheel 24. Top cover
 25. Air outlet 26. Ethernet input

First Print

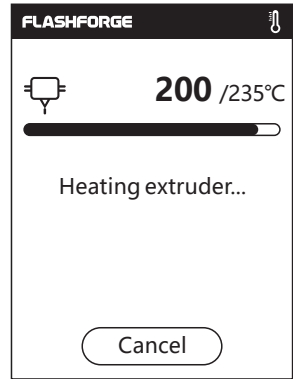
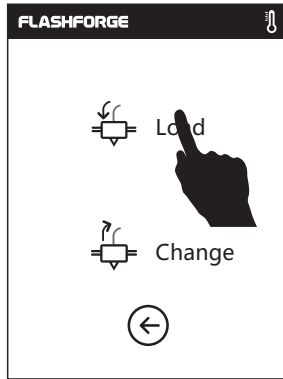
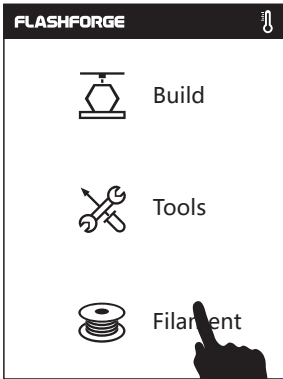

1. Tap [Filament], tap [Load], after load completed, tap [OK].

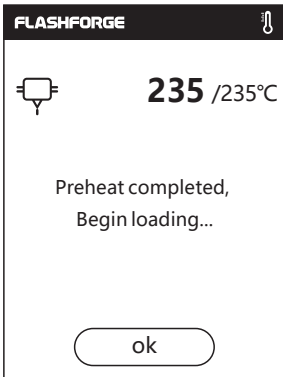

2. As shown on the left, loading starts when the extruder heated to target temperature.

3. Open the filament cover, insert the filament into the filament intake, push filament into the feeding wheel until some resistance is sensed.

Note: Please make sure filament has been pushed into the feeding wheel!

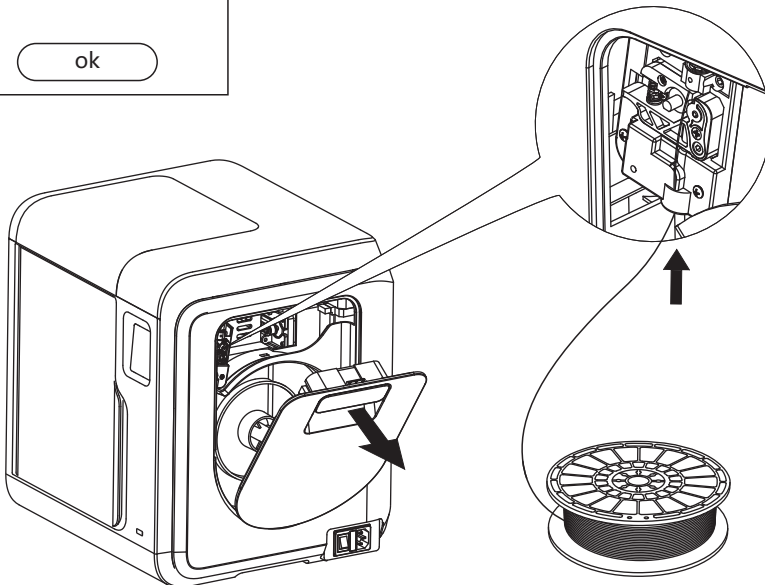

Mind the loading direction of filament, make sure to be clockwise as the picture showed.

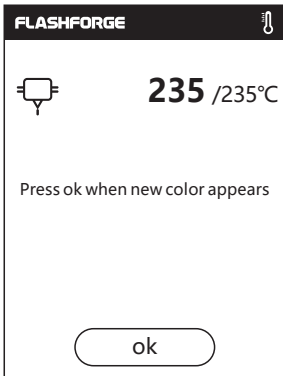
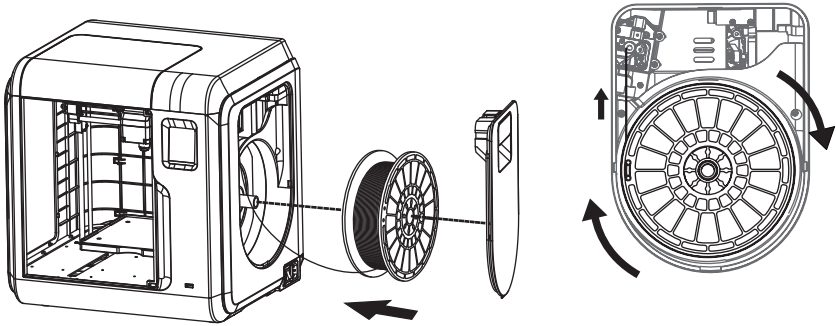

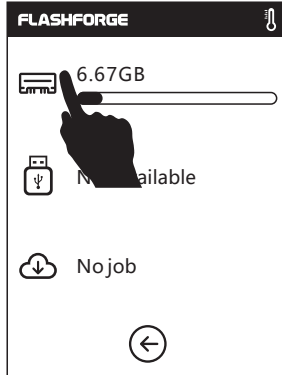
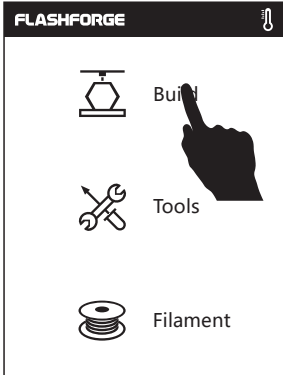

4. Load completed when you see filament come out of extruder, tap [OK]. Put the spool of filament on the spool holder, close the filament cover.

Model Print

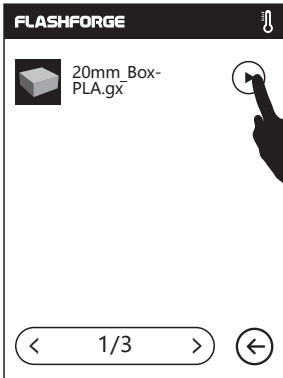

1. Tap [Build], choose the file path: Print from local memory card. 

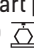

2. Locate the model file  in the model list, Tap  on its right to start printing; or tap model file picture or file name to enter model details page, tap  to start printing.

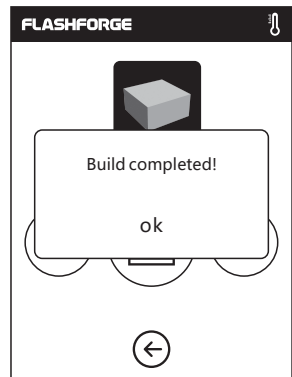
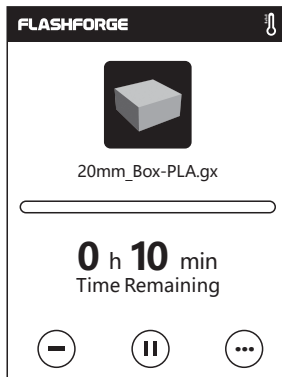
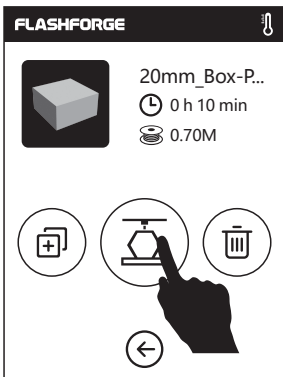

3. Extruder will heat up and printer will start printing after heating completed. After model printing finished, printer will sound a beep and pop out notice on touch screen.

Model Remove

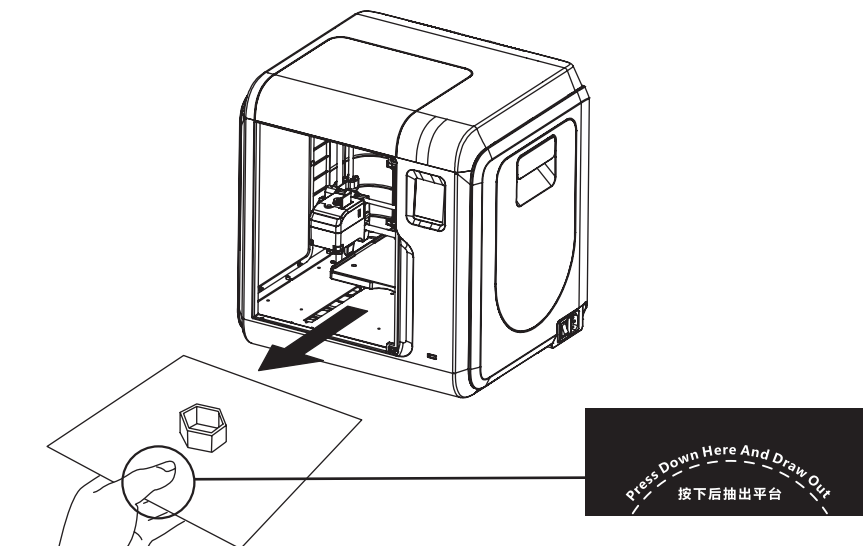

1. As showed in picture, press down dotted line area and draw out the removable build plate.

⚠ Notices

When printing completed, extruder and build plate may still hot, please start operating after cooling down!

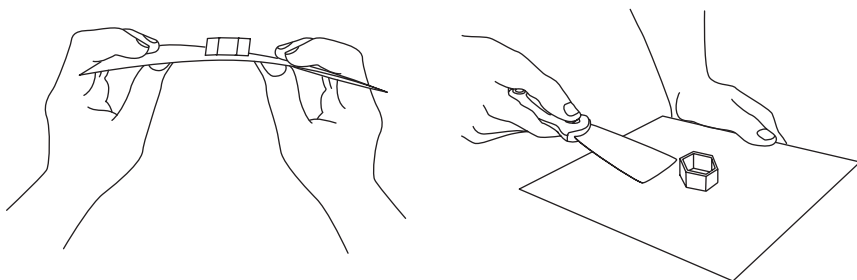

2. Bend the build plate, the plate will produce certain deformation, seperating the plate away from the bottom of model (Please use a scraper to assist removing when model is too small or big).

Change Filament

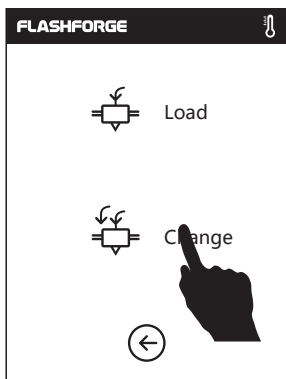

1. Tap [Filament], tap [Change], extruder starts preheating.

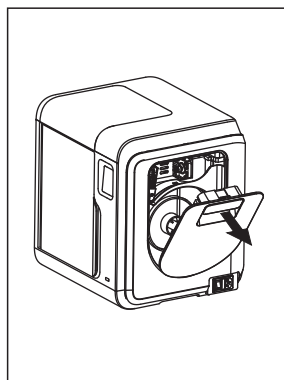
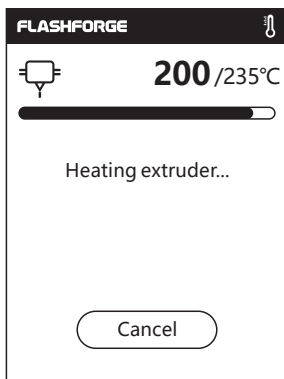

2. Open the filament cover.

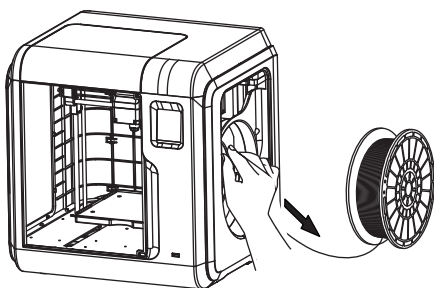

3. Pull out the filament as the picture showed above.

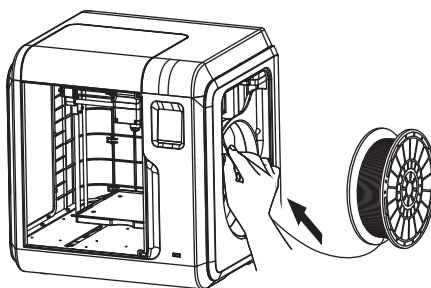

4. Insert new filament into the filament intake and push the filament into the feeding wheel until resistance is sensed.

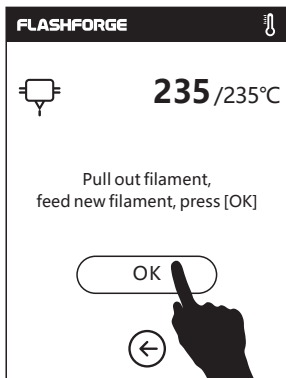

5. Tap [ok] after plugging in new filament, loading starts. When new filament come out of extruder steadily, replace is completed, tap [OK].

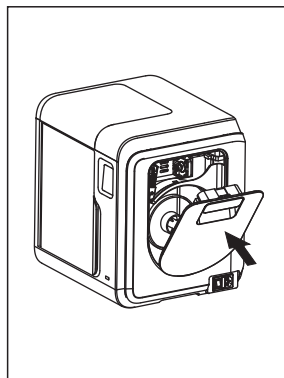
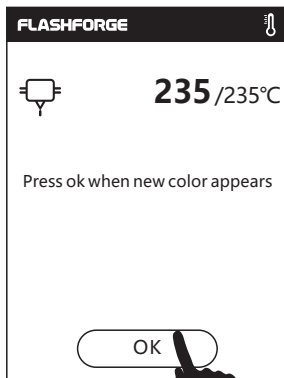

6. Put the spool of filament on the spool holder, close the filament cover.

开箱



1. 打开纸箱。



2. 取出顶部的纸塑盒，在纸塑盒上装有一份快速启动指南、一份售后服务卡、一个工具包、一根电源线 and 一卷耗材。



3. 从纸箱中抱出打印机，去除包裹打印机的气泡袋。



4. 撕除打印机上的固定胶带和前门保护袋。



5. 取出电源线，插入打印机电源线接口。

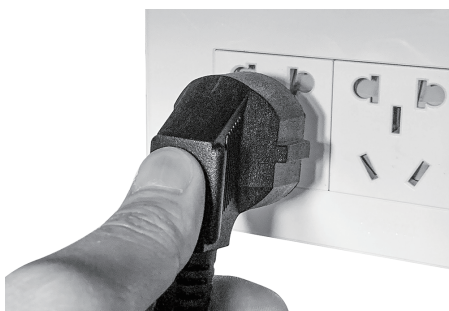

6. 将电源线另一头插入插座，接通电源。



7. 打开电源开关开机。



8. 打开打印机前门，准备取出内部的纸塑盒。

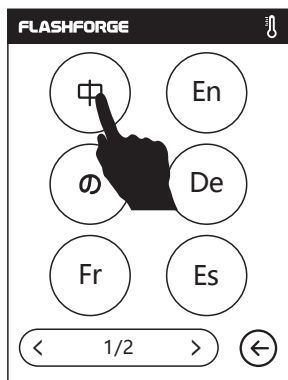
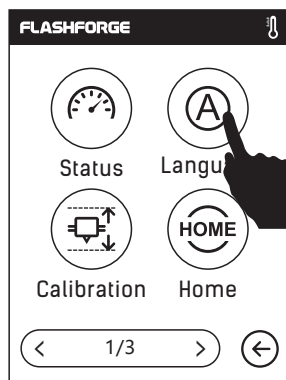
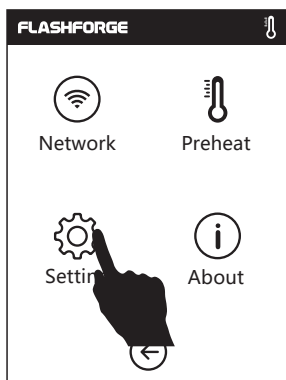
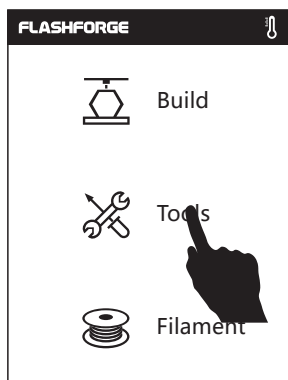

9. 冒险家3打印机在出厂时默认设置是英文，请根据以下设置转换为中文。在触摸屏上依次点击[Tools]、[Setting]、[Language]、[中文]，然后点击返回箭头返回。

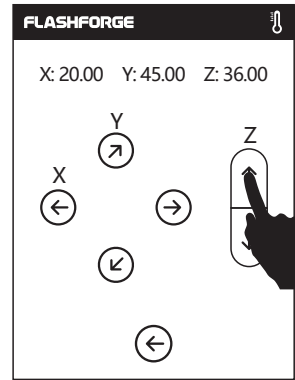
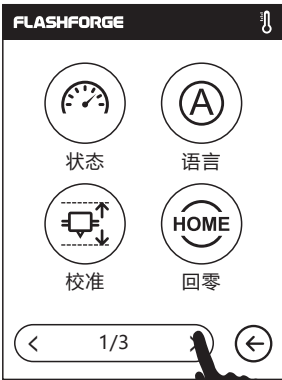

10. 在屏幕上点击向右翻页的箭头进入第二页，点击[移动]。在移动界面按住Z轴向上的箭头升起打印平台，以便取出下方的纸塑盒。移动完成后点击返回键返回主界面。

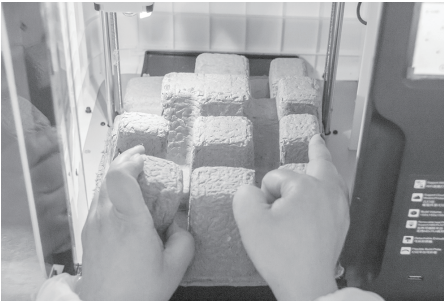

11. 轻轻向中间挤压纸塑盒，然后取出。



12. 开箱完成！建议您保管好这些包装材料，便于以后的搬运或保存。

装箱物品

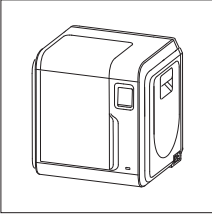

3D打印机

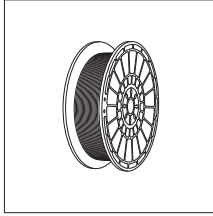

3D打印耗材

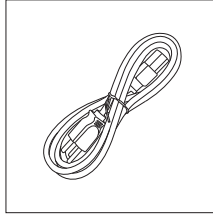

电源线



售后服务卡

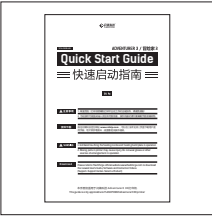

快速启动指南

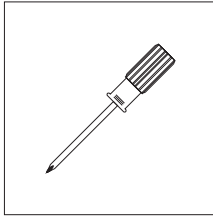

十字螺丝刀

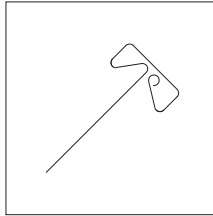

通针

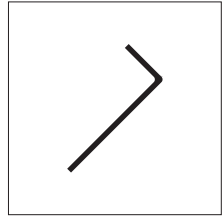

内六角扳手

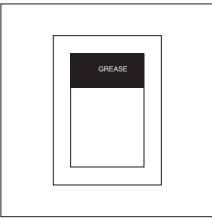

润滑脂

部件介绍

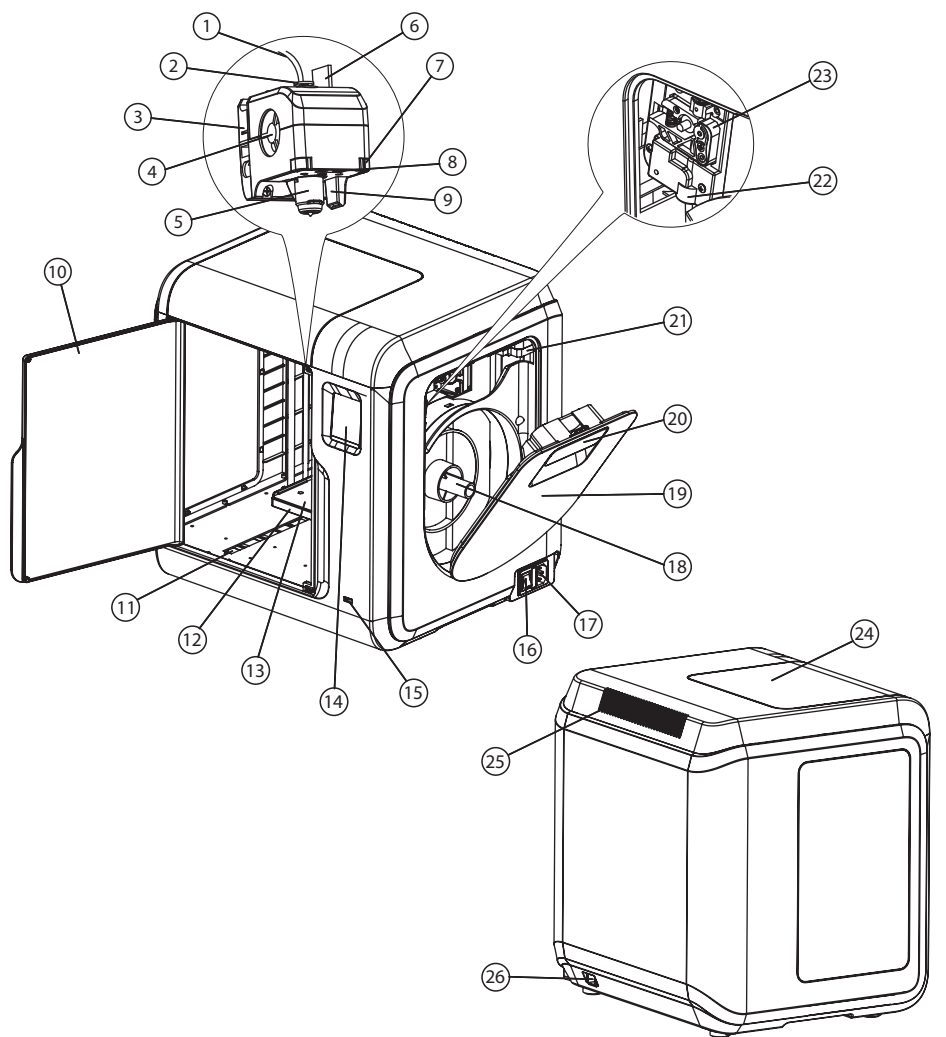

- | | | | | |
|----------|-----------|------------|-----------|-----------|
| 1. 导丝管 | 2. 导丝管接头 | 3. 喷头座 | 4. 风扇 | 5. 可拆卸喷嘴 |
| 6. 喷头排线 | 7. 夹扣 | 8. Led灯 | 9. 导风嘴 | 10. 前门 |
| 11. Y轴滑槽 | 12. 平台座 | 13. 可移除平台板 | 14. 触摸屏 | 15. U盘接口 |
| 16. 电源开关 | 17. 电源线接口 | 18. 料盘架 | 19. 丝盘盖 | 20. 丝盘盖把手 |
| 21. 电机 | 22. 进丝口 | 23. 送丝轮 | 24. 上盖透明板 | 25. 出风口 |
| 26. 网线接口 | | | | |

填装耗材

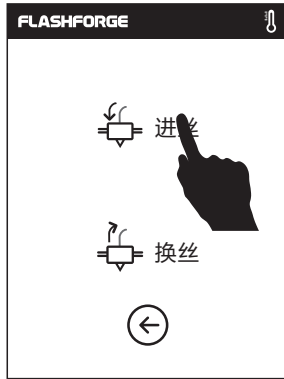

1. 点击屏幕中的[换丝]-选择[进丝]-喷头开始加热。



2. 如左图所示, 喷头加热到目标温度后开始进丝。

3. 如下图所示, 打开料盘盖, 将丝料插入进丝口, 推入送丝轮内, 感受到一定阻力时即可。

注: 请务必确认丝料已推入送丝轮!

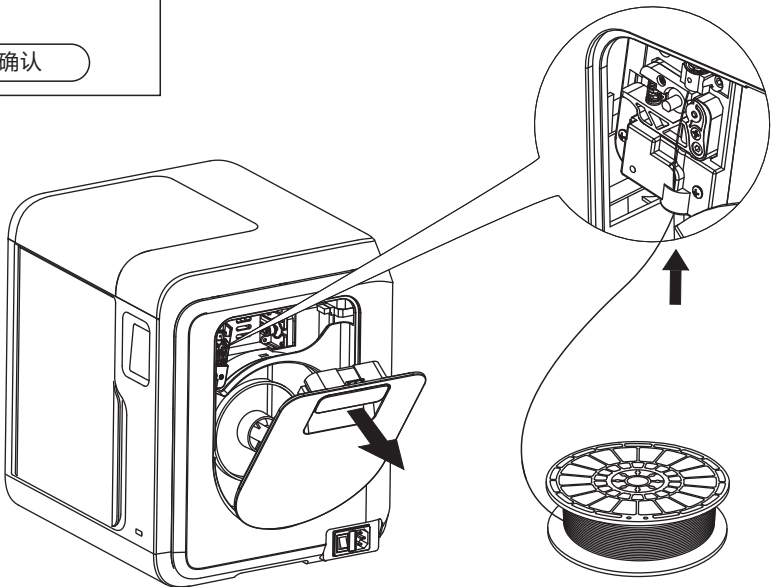

请务必注意丝盘的出丝方向，确保按图中所示方向（顺时针）出丝。

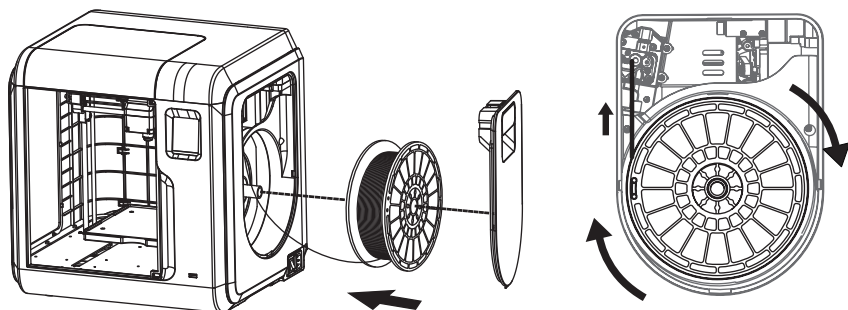

4. 当喷嘴开始出丝时请勿立即停止进丝，直到耗材均匀出丝为止。将耗材置于料盘架上，盖上料盘盖。



5. 点击[确认]，返回主界面。

首次打印

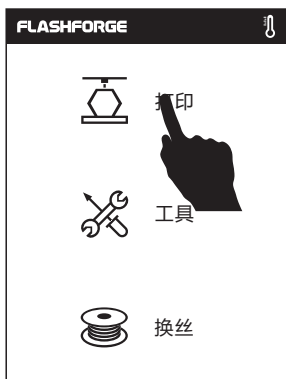

打印建议

1. 打印开始前请确保耗材安装正确，没有打结或卡住；
3. 喷头内可能残留少量耗材，请进丝一段时间，确保上一次打印的耗材已全部挤出；
4. 打印开始前请将喷头耗材清理干净；
5. 不可以长时间无人看守的情况下使用3D打印机；

1. 选择[打印] - [内部存储]。

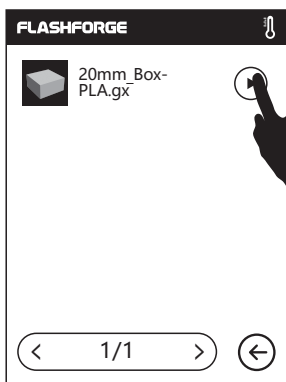

2. 在模型列表中选择  模型，点击  开始打印；或点击模型图片或文件名进入模型详情页，然后点击  开始打印。

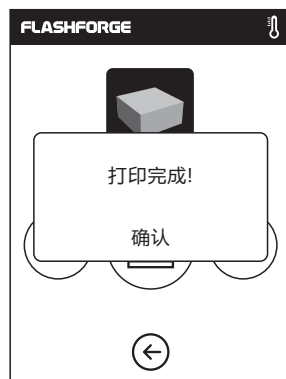
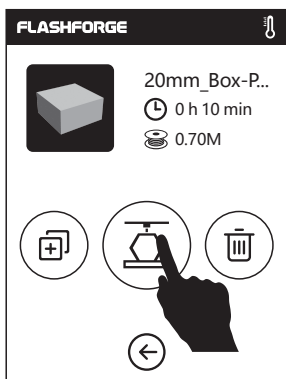

3. 打印时喷头将会升温，当温度达到目标值时开始打印。模型打印完成后，打印机将会发出提示声，同时屏幕弹出完成提示。

模型移除

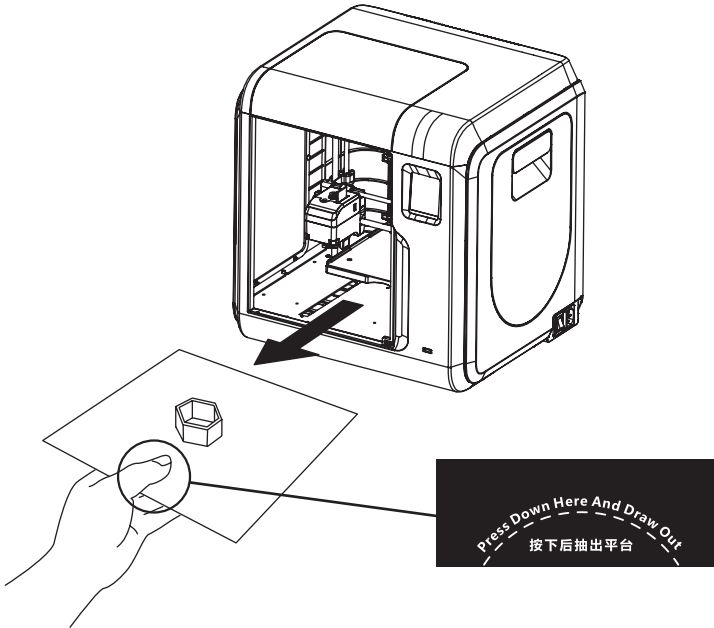

1. 如上图所示，在虚线区域向下按压，同时向外抽出打印平台。

⚠ 注意事项

打印完成时，喷嘴和打印平台可能仍处于高温状态，建议冷却后再进行取模型操作！

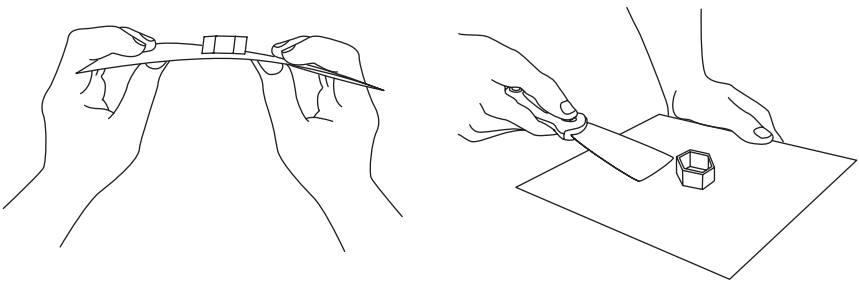

2. 弯折平台板，平台板会有一定形变与模型底部脱离（模型较小或较大时建议使用铲刀辅助）。

更换丝料

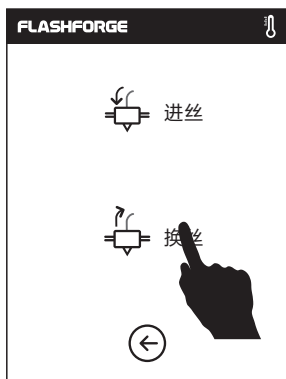

1. 点击[丝料]-[换丝]，喷头将启动加热。

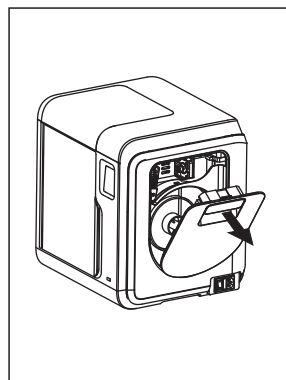

2. 打开料盘盖。

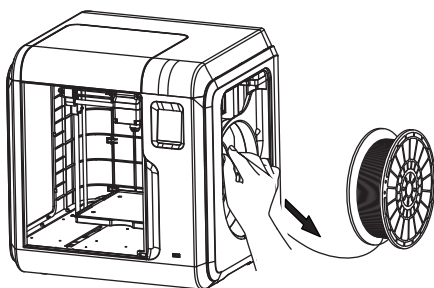

3. 根据屏幕提示拔出丝料。

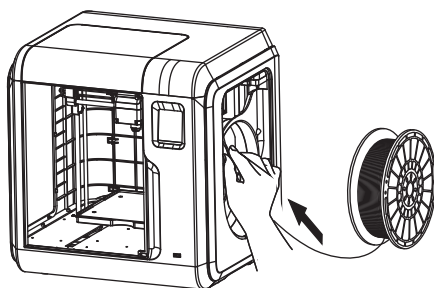

4. 将新丝料插入进丝口，推入送丝轮内，感受到一定阻力时即可。



5. 新耗材插入后点击[确认]开始进丝。看到耗材从喷头均匀出丝后，说明换丝完成，点击[确认]。

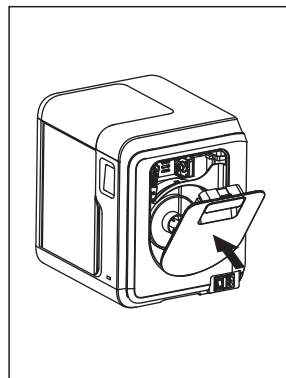

6. 将新料盘置于料盘架上，盖上市盘盖。



YouTube



优酷自频道

Scan QR to Get More
After-Sales Support
扫描二维码获得更多售后支持



浙江闪铸三维科技有限公司
FLASHFORGE CORPORATION

售后专线 : support@flashforge.com After-Sales Service: support@flashforge.com

电话 : 4008866023 官方网站 : www.sz3dp.com 地址 : 浙江省金华市仙源路518号
Tel: +86 579 82273989 Web: www.flashforge.com Add: 2/F, No.518, Xianyuan Road, Jinhua, Zhejiang, China